

**COLLEGE OF SOUTHERN IDAHO  
BOARD OF TRUSTEES**

**December 18, 2006**

**EXECUTIVE SESSION**

**5:00 p.m.**

**Taylor Building – President’s Board Room**

**BOARD OF TRUSTEES MEETING**

**6:00 p.m.**

**Taylor Building – SUB 248**

**AGENDA**

**MINUTES – EXECUTIVE SESSION OF NOVEMBER 20 : (A) *Mike Mason***

**MINUTES – REGULAR MEETING OF NOVEMBER 20: (A) *Mike Mason***

**MINUTES – EXECUTIVE SESSION OF DECEMBER 11 : (A) *Mike Mason***

**HEAD START BUS BID: (A) *Mike Mason***

**DATE CHANGE FOR JANUARY BOARD MEETING (1/29/06): (A) *Mike Mason***

**STATE BOARD OF NURSING SITE VISIT: (I) *Claudeen Buettner***

**SOFTBALL FIELD LOCATION SELECTION: (I) *Randy Dill***

**BUS STOP DESIGN: (I) *Randy Dill***

**PRESIDENT’S REPORT: (I) *President Beck***

**OLD BUSINESS**

**NEW BUSINESS**

COLLEGE OF SOUTHERN IDAHO  
COMMUNITY COLLEGE DISTRICT  
DECEMBER BOARD OF TRUSTEES MEETING  
DECEMBER 18, 2006

CALL TO ORDER: 5:50 p.m. Presiding: LeRoy Craig

Attending: Trustees: LeRoy Craig, Dr. Charles Lehrman,  
Donna Brizee, Dr. Thad Scholes and Dr. Allan Frost

College Administration: Gerald L. Beck, President  
John M. Mason, Secretary/Treasurer  
Dr. Claudeen Buettner, Executive Vice President and  
Chief Academic Officer  
Curtis Eaton, Vice President of Planning and  
Development  
Cindy Bond, Instructional Dean  
Graydon Stanley, Dean of Students  
Scott Scholes, Director of Advising Center  
Gail Schull, Registrar  
Monty Arrossa, Director of Human Resources  
Randy Dill, Physical Plant Director  
Doug Maughan, Public Information Director  
Karen Baumert, Sports Information Director  
Kathy Deahl, Administrative Assistant to the  
President

CSI Employees: Jeff Harmon, Nick Baumert

Visitors: Angela Essma

Faculty Representative: Janet Sandy

PACE Representative: Shelby Carter

Times News: Josh Palmer

MINUTES OF THE EXECUTIVE SESSION OF NOVEMBER 20, 2006, THE  
REGULAR SESSION OF NOVEMBER 20, 2006 AND THE EXECUTIVE SESSION  
OF DECEMBER 11, 2006 were approved as written on MOTION by Dr.  
Thad Scholes. Affirmative vote was unanimous.

TREASURER'S REPORT: The Treasurer's report was approved on  
MOTION by Dr. Charles Lehrman. Affirmative vote was  
unanimous.

BIDS:

1. The Board approved the low bid of Western Bus Sales of Nampa, Idaho for the specified bus in the amount of \$85,083.00 on MOTION by Dr. Allan Frost. Affirmative vote was unanimous.  
Funding for this purchase is from Head Start grant funds.

PRESIDENT'S REPORT:

1. The date for the January board meeting was changed from January 22, 2007 to January 29, 2007 on MOTION by Donna Brizee. Affirmative vote was unanimous.

The date was changed to allow the college administration to participate in Education Week at the Idaho State Legislature.

2. Dr. Claudeen Buettner reported the Idaho Board of Nursing conducted a regular five year site visit to review the practical nursing program. The site visit resulted in no recommendations and accommodations for faculty credentials, curriculum, clinicals, engaged faculty, administrative resources, partnership with the registered nursing program and continuing education opportunities for faculty.

The Board thanked Dr. Buettner and the nursing department for their outstanding work.

3. Randy Dill described the location for the new softball field and presented a budget of \$75,000 to complete the first phase of construction. The first phase will include the field, dugouts, batting cages and fencing. Softball coach Nick Baumert stated that a fundraising effort would be started to pay for a scoreboard.

The construction of the field will begin in the spring of 2007 with planned use of the field beginning in the fall of 2007.

President Beck thanked Nick Baumert, Karen Baumert and Randy Dill for their work on the design of the field.

4. Randy Dill reviewed the design for landscaping for the bus stop area. The design was professionally completed by Martha Carlson at no cost to the College. The landscaping will be completed in the spring of 2007.

ADJOURNMENT was declared at 6:48 p.m.

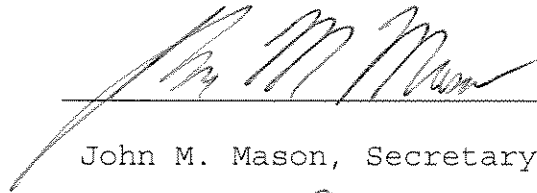

---

John M. Mason, Secretary-Treasurer

Approved: January 29, 2007



---

Chairman



December 14, 2006

To: President Beck and the College of Southern Idaho Board  
of Trustees

From: Mike Mason

Re: Head Start Bus Bid

We received two qualified bids for the specified bus.  
The bids are as follows:

Company	Price
Western Bus Sales	\$85,083
Bryson Sales and Service	\$86,416

Based upon a review of the bids by Jay Thurber and Mary Marshall of Head Start, I recommend that we accept the low bid of Western Bus Sales of Nampa, Idaho in the amount of \$85,083.

Funding for this purchase is from Head Start grant funds.

## **CSI Softball Field Estimated Budget Cost**

### **PHASE ONE**

Infield/Outfield- Diamond Dust/Cinders	\$	3,500.00
Earth Work	\$	6,000.00
Survey/Engineering of Field	\$	1,000.00
Irrigation/Sprinklers/Seeding	\$	15,000.00
	<b>\$</b>	<b>25,500.00</b>

Dugouts/Cement 16" relief		
	<b>\$</b>	<b>22,000.00</b>

### **Field fencing**

Fence padding / Plastic coil padding	\$	800.00
Home Run Fence	\$	4,738.00
Sideline Fence	\$	2,160.00
Dugout Fence	\$	630.00
Post concrete	\$	500.00
Exterior Security Fence	\$	8,073.00
Bull Pen Post	\$	960.00
Back Stop Post	\$	3,310.00
	<b>\$</b>	<b>21,171.00</b>

Backstop Netting	\$	2,200.00
Batting Cage nets	\$	1,100.00
	<b>\$</b>	<b>3,300.00</b>

<b>PHASE ONE TOTAL</b>	<b>\$ 71,971.00</b>
------------------------	---------------------

### **PHASE TWO**

Proposed Building Estimate		
Includes the following:		
Restrooms, Announcers Booth, Storage,		
Plumbing, and Sewer hook up		
	<b>\$</b>	<b>75,000.00</b>

Concrete bleacher pads		
	<b>\$</b>	<b>25,560.00</b>

Field lighting	\$	42,000.00
for night friendly lighting	\$	1,495.00
	<b>\$</b>	<b>43,495.00</b>

<b>PHASE TWO TOTAL</b>	<b>\$ 144,055.00</b>
------------------------	----------------------

**\$ 216,026.00 Grand Total**

Lot 7

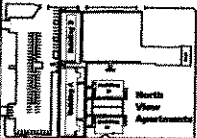
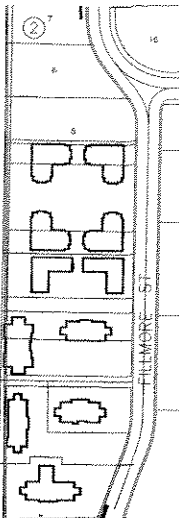

**Proposed Softball Diamond Location**

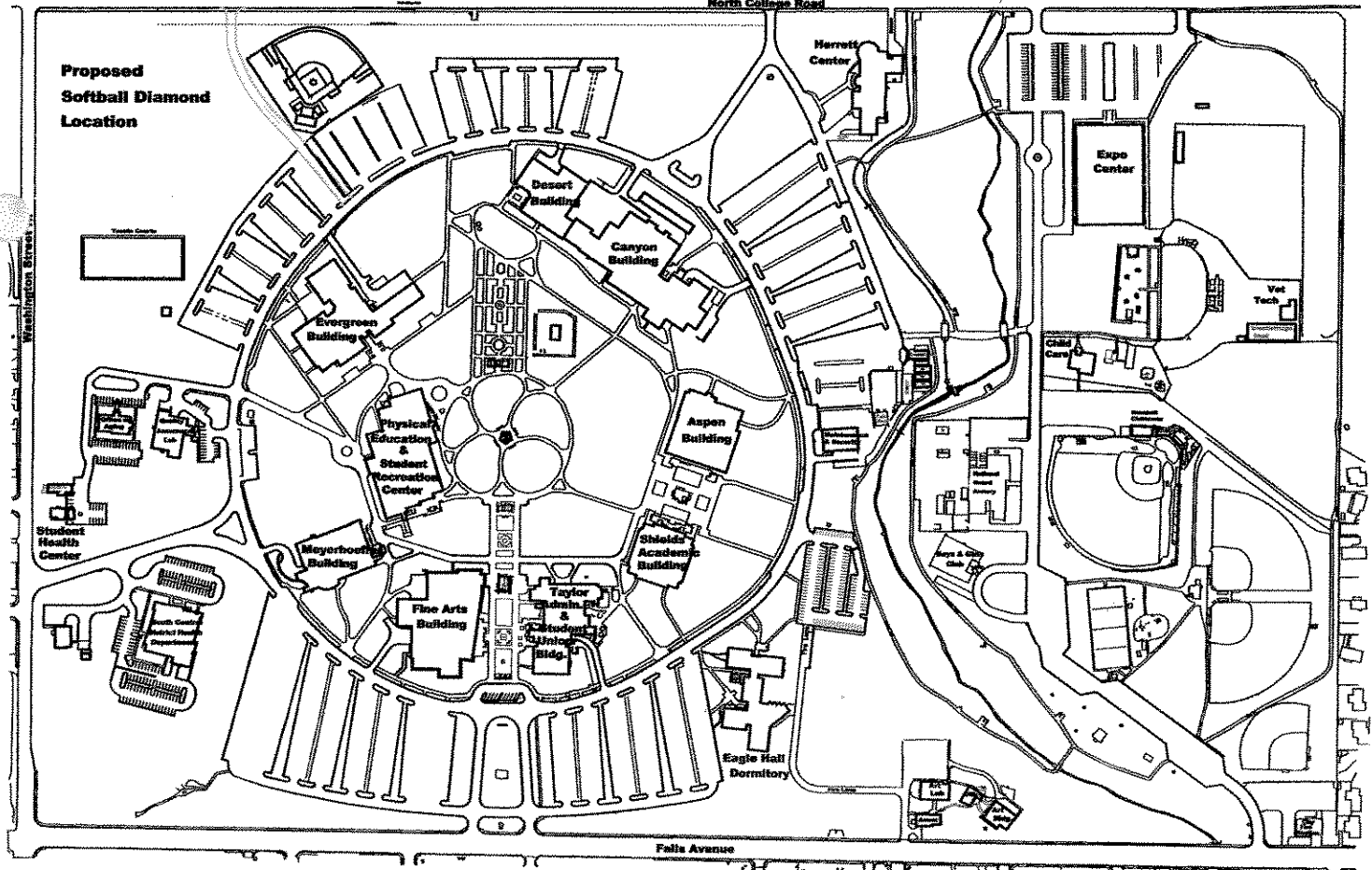

approximate berm line

# CSI Softball Diamond

December 14, 2006

Home Run Fence

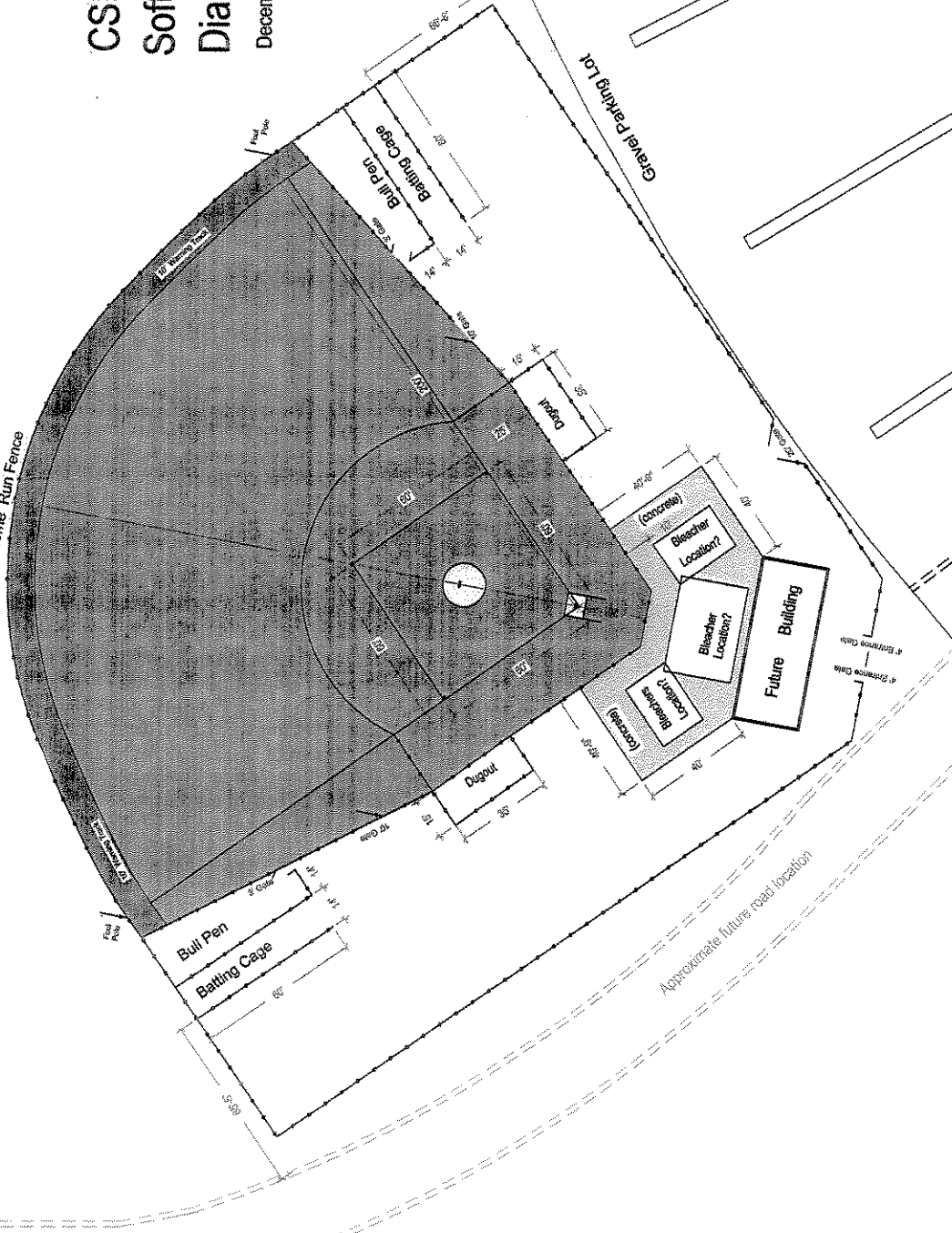

Gravel Parking Lot

Approximate future road location