

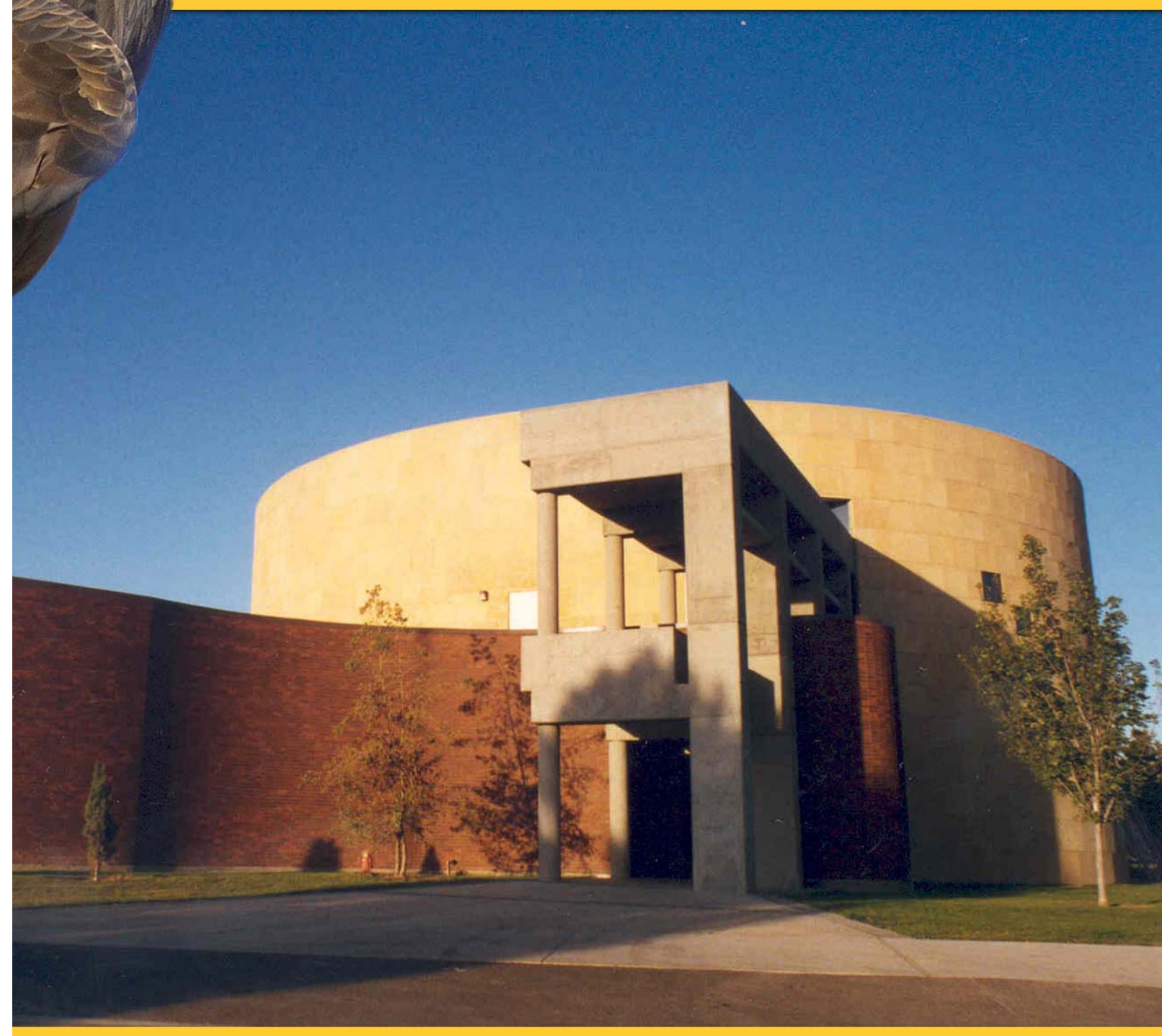

# Standard Eight: Physical Resources





## Standard Eight: Physical Resources

- 8.1 Campus Map
- 8.2 Educational Building List
- 8.3 Graph Depicting Room Usage at Different Times of Day
- 8.4 List of Faculty Office Additions
- 8.5 Fall 2003 Accreditation Survey Questions #57 and #58
- 8.6 List of Equipment in Rooms
- 8.7 Example of Work Order
- 8.8 Fall 2003 Accreditation Survey Questions #61-#64
- 8.9 Emergency Phone Runner Tree
- 8.10 Graph Depicting Decrease in Professional-Technical Capital Outlay
- 8.11 Historical Plant Facility Fund Balances
- 8.12 Plant Facility Fund Projections
- 8.13 Herrett Center Map and Information
- 8.14 Blaine County Outreach Center Map
- 8.15 Mini-Cassia Outreach Center Map
- 8.16 North Side Outreach Center Map



# Appendix 8.1 Campus Map

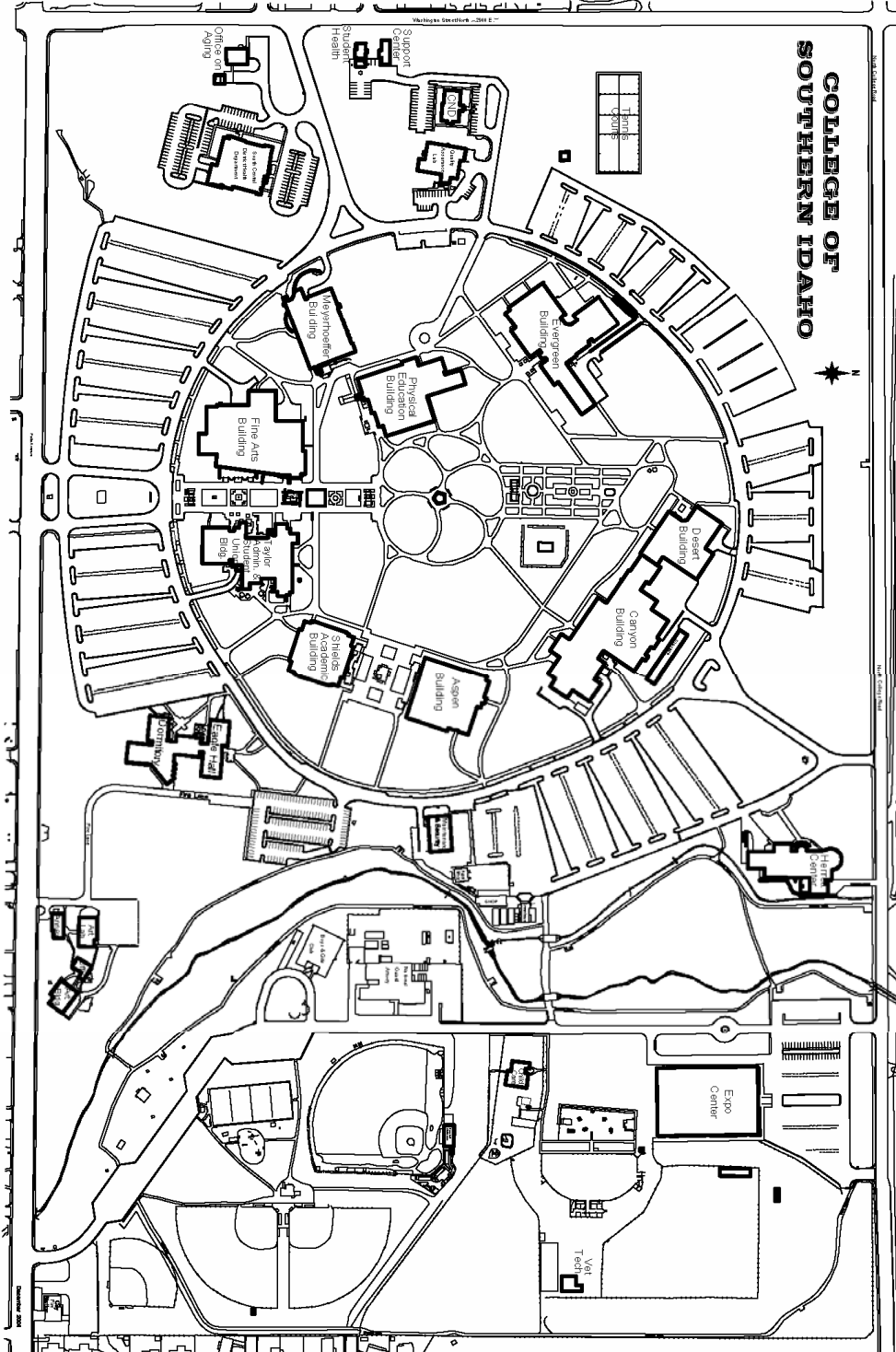



## Appendix 8.2

### Educational Building List

COLLEGE OF SOUTHERN IDAHO			
EDUCATIONAL BUILDINGS			
APRIL 28, 2004			
YEAR	BUILDING	GROSS SF	ASSIGNABLE SF
1968	FINE ARTS	25,649	20,991
1968	SHIELDS	55,484	29,706
1968	ART OFFOCE BUILDING	2,557	1,570
1970	GYM	45,413	35,597
1970	TAYLOR	47,668	25,659
1970	ASPEN	19,060	13,654
1976	CANYON	70,355	60,306
1978	ART POTTERY LAB	3,116	2,812
1981	DESERT BUILDING	28,819	24,254
1986	TAYLOR ADDITION	7,500	3,000
1990	EVERGREEN SIDC WING C	12,630	8,335
1991	ART PHOTOGRAPHY LAB	3,649	2,445
1992	FINE ARTS ADDITIION	3,452	2,890
1992	EVERGREEN WINGS A & B	39,800	26,268
1993	NEW CND	4,500	2,800
1995	HERRETT MUSEUM ADD (PLANETARIUM)	10,904	
1996	LIBRARY/ACADEMIC DEV CENTER	53,843	
1996	GYM ADDITION	11,560	
1998	DESERT CANYON CONNECTION	4,200	
1998	BURLEY HIGH SCHOOL	60,000	
2004	HERRETT ADDITION (OBSERVATORY)	9,625	
2005	FINE ARTS ADDITIION	42,165	
1965	LIBRARY ANNEX	2,954	790
1980	HERRETT MUSEUM	13,393	9,034
1987	FISH HATCHERY BLDG	6,128	4,000
2000	ASPEN ADDITION	13,896	
2001	VET TECH MEDICAL BLDG	1,600	
	<b>Total</b>	<b>599,920</b>	<b>274,111</b>

### Appendix 8.3 Graph Depicting Room Usage at Different Times of Day

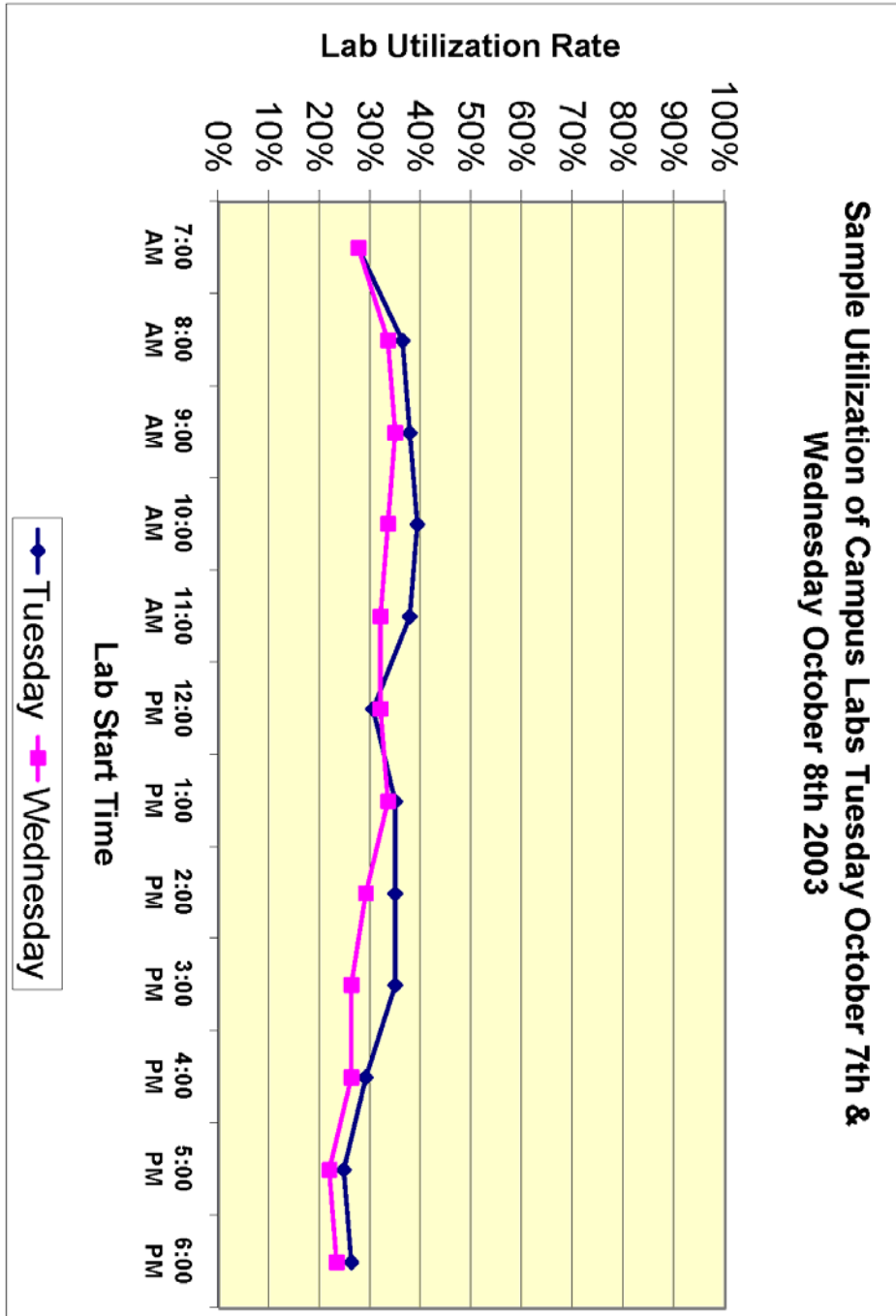

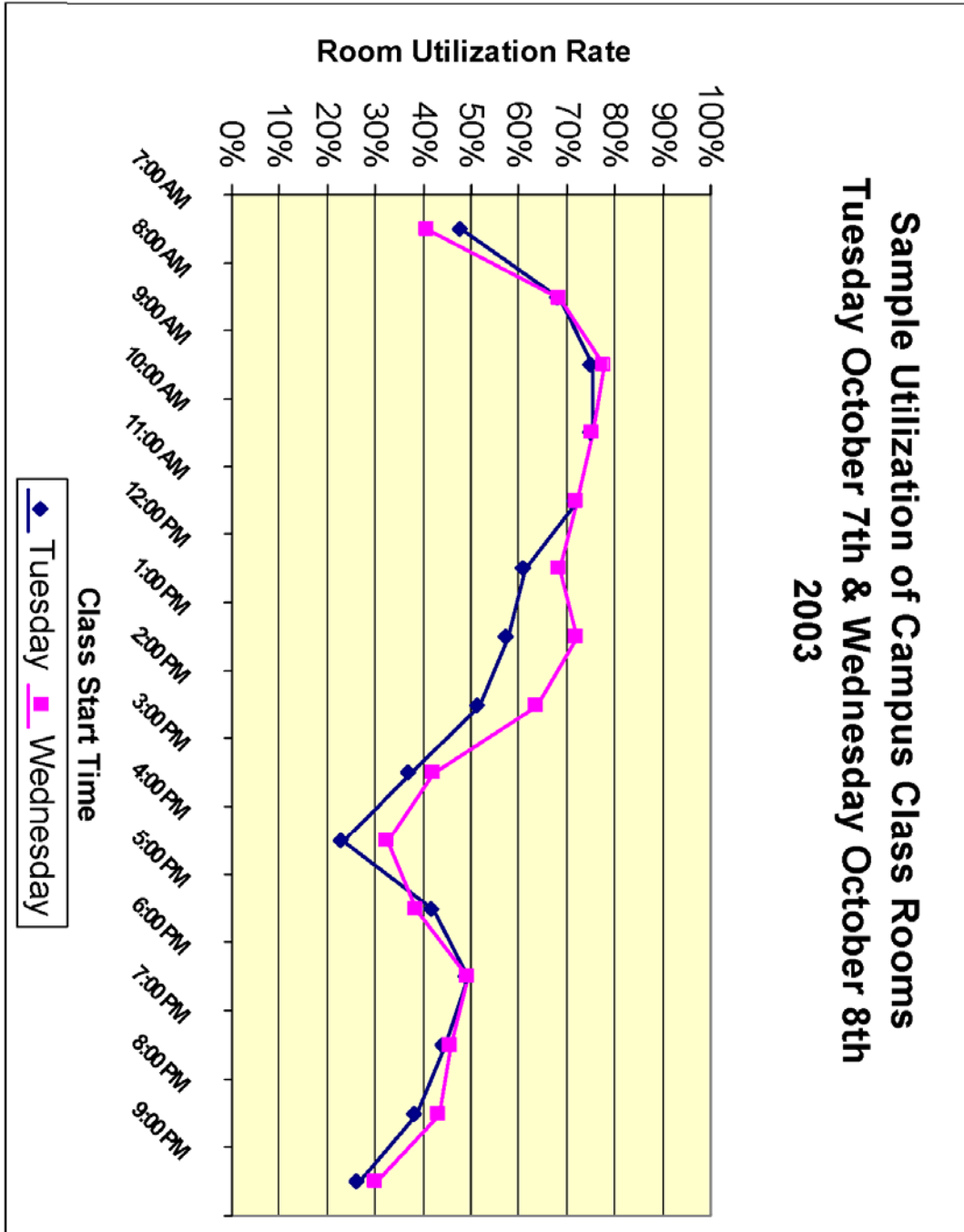





College of Southern Idaho  
Room Utilization

Room Type	Class Room		Class Room	
Date	10/7/2003		10/8/2003	
	Tuesday		Wednesday	
Total Available	84		84	
7:00 AM 8:00 AM	40	47.62%	34	40.48%
8:00 AM 9:00 AM	57	67.86%	57	67.86%
9:00 AM 10:00 AM	63	75.00%	65	77.38%
10:00 AM 11:00 AM	63	75.00%	63	75.00%
11:00 AM 12:00 PM	60	71.43%	60	71.43%
12:00 PM 1:00 PM	51	60.71%	57	67.86%
1:00 PM 2:00 PM	48	57.14%	60	71.43%
2:00 PM 3:00 PM	43	51.19%	53	63.10%
3:00 PM 4:00 PM	31	36.90%	35	41.67%
4:00 PM 5:00 PM	19	22.62%	27	32.14%
5:00 PM 6:00 PM	35	41.67%	32	38.10%
6:00 PM 7:00 PM	41	48.81%	41	48.81%
7:00 PM 8:00 PM	37	44.05%	38	45.24%
8:00 PM 9:00 PM	32	38.10%	36	42.86%
9:00 PM 10:00 PM	22	26.19%	25	29.76%

	Tuesday	Wednesday
7:00 AM	47.6%	40.5%
8:00 AM	67.9%	67.9%
9:00 AM	75.0%	77.4%
10:00 AM	75.0%	75.0%
11:00 AM	71.4%	71.4%
12:00 PM	60.7%	67.9%
1:00 PM	57.1%	71.4%
2:00 PM	51.2%	63.1%
3:00 PM	36.9%	41.7%
4:00 PM	22.6%	32.1%
5:00 PM	41.7%	38.1%
6:00 PM	48.8%	48.8%
7:00 PM	44.0%	45.2%
8:00 PM	38.1%	42.9%
9:00 PM	26.2%	29.8%



**Appendix 8.4**  
**List of Faculty Office Additions**

<b>COLLEGE OF SOUTHERN IDAHO</b>		
<b>FACULTY OFFICES ADDED</b>		
<b>1992 - 2004</b>		
<b>YEAR</b>	<b>BUILDING</b>	<b># OF OFFICES</b>
1992	EVERGREEN WINGS A & B	16
1996	CANYON REMODEL - ABE MOVED TO LIBRARY	6
1996	SHIELDS REMODEL	5
1996	GYM ADDITION	3
1996	LIBRARY/ACADEMIC DEV CENTER	10
1998	DESERT CANYON CONNECTION	1
2001	ASPEN ADDITION	17
2004	ASPEN - OLD ITC - REMODEL	4
2004	CANYON LANGUAGE LAB REMODEL	4
	<b>TOTAL</b>	<b>66</b>

## Appendix 8.5 Fall 2003 Accreditation Survey Questions #57 and #58

### Question #57

Would you agree that:	Total					Total Percent in Agreement	Total Percent in Disagreement
	SD	D	A	SA	DK/ NA		
There are adequate offices for full-time staff?	4.5%	16.3%	43.0%	11.8%	24.3%	54.8%	20.8%

KEY: SD=Strongly Disagree D=Disagree A=Agree SA=Strongly Agree DK/NA=No Opinion/Does Not Apply.

Includes responses from fall 2003 survey of students, faculty, staff and administration.

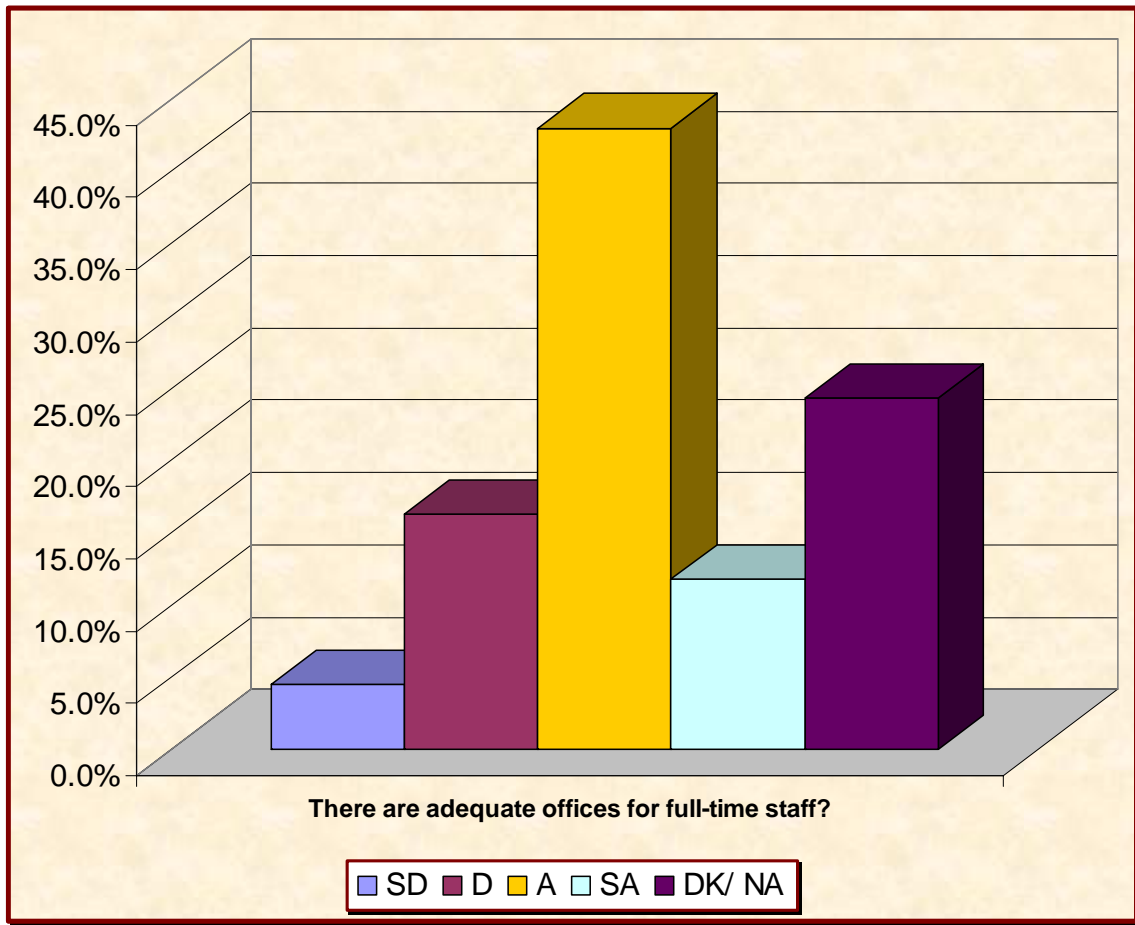

Question #58

Would you agree that:	Total					Total Percent in Agreement	Total Percent in Disagreement
	SD	D	A	SA	DK/ NA		
There are adequate offices for part-time staff?	6.8%	21.9%	35.1%	8.0%	28.3%	43.1%	28.7%

KEY: SD=Strongly Disagree D=Disagree A=Agree SA=Strongly Agree DK/NA=No Opinion/Does Not Apply.

Includes responses from fall 2003 survey of students, faculty, staff and administration.

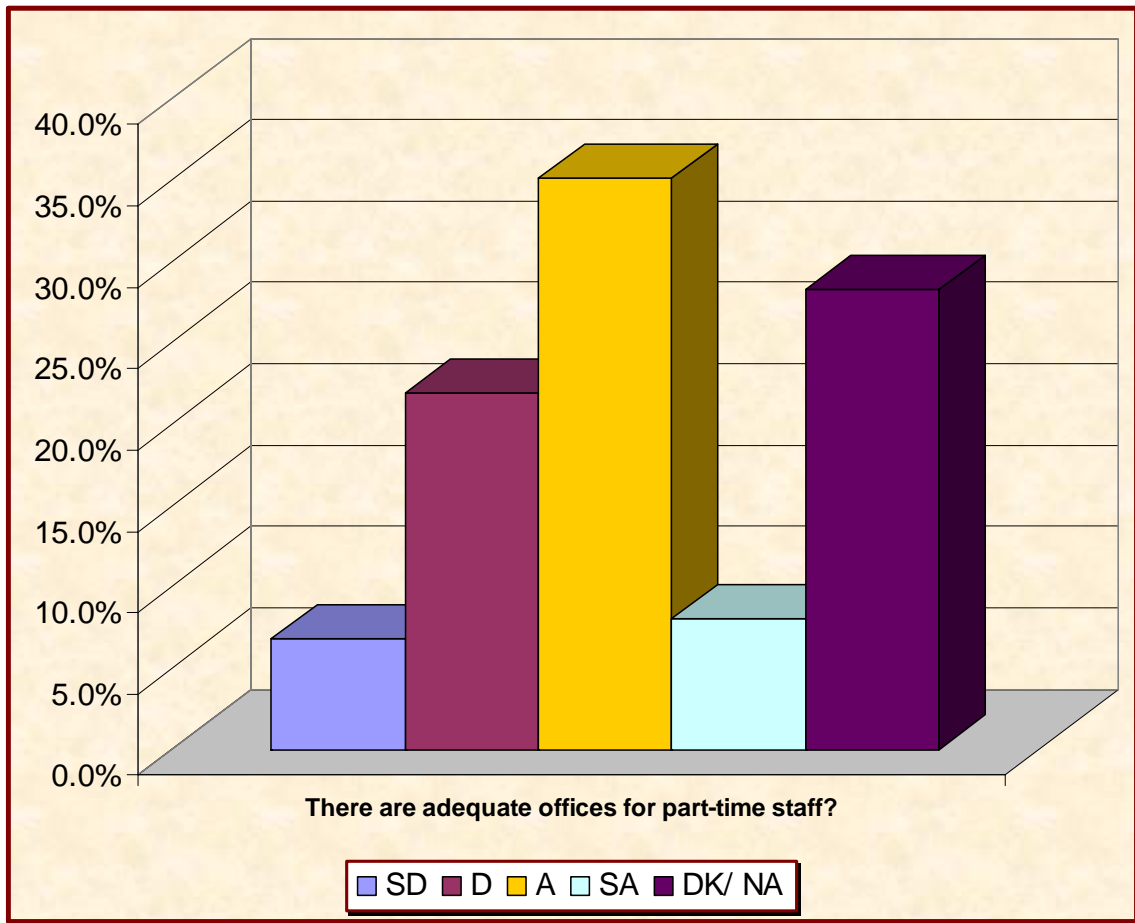

## Appendix 8.6 List of Equipment in Rooms

Building	Room	Computer	Laptop Access	Teaching Station	Screen	Projection System	Sound System	Elmo	VCR, Video	TV (size)	Monitor
Aspen	108	Micron ClientPro CN-800	1	1	12' x 18' Dalite 4/02 replaced	EzPro 615H 1	Optimus Speakers		Panasonic 4H 1		
	Floater					EzPro 753 1					
	Cart	Dell		1		EzPro 610H 1					
	Floater					EzPro 753 1					
	Floater					EzPro 757 1					
	131	IBM	1								9"
			2								
	134	NO		1	1	6 ft	EzPro 750 1	notis wired			
	139	Dell PIII 933MHz	1	1	1	7' x 7' Dalite	EzPro 610H 1	SoundTech	EV368	Panasonic 1	
	140										
	144	Micron w/flat screens	17	1	1	yes	EzPro 753 1	Pyle Pro	EV400AF	Sony 1	
							Epson ELP 7550 1	yes	EV400AF	Samsung 1	
	145	NO		1	1	6 ft	EzPro 750 1	notis wired			
	150	Dell	1	1	1	smart board & 8' x 8' Dalite	EzPro 753 1	CV-Rex		yes	1
	179										
180	Dell P4	1	1	1	5' x 5' Dalite	EzPro 753 1	Pyle Pro		Sony 1		
181	Micron PIII 800MHz	1	1	1	8' x 8' Dalite	EzPro 750 1	CV - Rex	EV400 AF	yes	1	
181	Micron PIII 800MHz	1	1	1	wall paper	EzPro 610H 1	SoundTech	EV400 AF	Panasonic 1		
195	Micron PIII 800MHz	1	1	1	wall paper	EzPro 610H 1	SoundTech	EV4400 AF	JVC 4H HIFI 1	RCA 48" 4	
<b>Canyon</b>											
	101	Comner Creek	1		1	wall paper	EzPro 610H 1				
	106	DELL	1	1	1	8 x 8 Dalite	EzPro 753 1	Pyle Pro	EV4400 AF	dvd/vcr	1
	107										
	110E				table						
	113	yes	17		1						
		ComnerCreek PIII 667	2								
	115	Comner Creek PIII 1GHz	21		1	7' Dalite	EzPro 610H 1	Sony	EV400 AF	JVC 4H HIFI 1	Pana-sonic 9"
	119	yes	1	1	1	8' x 10'	EzPro 757 1	yes	EV 368		Toshiba 60" 2
	122	yes			1	yes	Epson ELP6550C 1				Hitachi
	123		1			5' Dalite	EzPro 753 1				
	124A		1		1	8' x 8' Dalite	EzPro 750 1	SoundTech	DT100 AF	yes	Zenith 40" 1
	124B	P100 Aurora	17		1	8' x 8' Dalite					Magnavox 24" 1
	124C	Computer Mart 486SSX33	21	1	1	10' x 10'	EzPro 610H 1		Quasar 4H 1	Quasar 24" 1	

Building	Room	Computer	Laptop Access	Teaching Station	Screen	Projection System	Sound System	Elmo	VCR, Video	TV (size)	Monitor			
	126				yes	EzPro 753	1							
	128				yes	EzPro 753	1							
	130A	DELL	1	1		BoxLight CP. 630i	1	yes	VID-P100	Mitsubishi 4H	1	Toshiba 48"	3	Hitachi
	135					EzPro 750	1		EV4400 AF					
	201				yes	equipment removed from room								
	202	wired to techno. then to 124E		1	yes	EzPro 610H	1	Pyle Pro		Sony	1			
	DELL													
<b>Desert</b>	104a		1	1	yes	EzPro 750	1	CV - Rex	EV400 AF	Panasonic	1			
	104c		1			EzPro 753	1	Radio Shack	yes	yes	1			
	112	Conner Creek PIII 550 MHZ (6) PIII 600 (1)		1	9' x 9' Dalite	Epson ELP 5550	1	SoundTech	EV400 AF	Mitsubishi 4H	1			
<b>Evergreen</b>	A05	Dell P4	1	1	yes	EzPro 750	1	Radio Shack		Panasonic	1			
	A06	Dell P4	1		5' Dalite	EzPro 753	1	Pyle Pro		Sony	1	Sony 27"	1	
	A15		1		yes	EzPro 610H	1	SoundTech		yes	1			
	A20	yes	1		6' x 6'	EzPro 610H	1	Optimus Speakers	DT100 AF	Quasar 4H	1	Sony 27"	1	
	A21	yes	2	1	6' x 8'	NEC MT 1035+ UI purchased	1	yes	DT100 AF	Magnavox	1	Toshiba 48"	1	
	A23	yes	1		10' x 10' Dalite	EzPro 610H	1			Quasar 4H	1	Quasar 24"	1	
	A24		1		6' x 6' Dalite	EzPro 610H	1			Mitsubishi	1	Sony 24"	1	
	C74	Micron PII 350	1	1	Dalite			outside source only	yes	JVC 4H	1	Mitsubishi 72"	1	
										Magnavox 27"	7			
	C93	Dell (8/2004)	24	1	Dalite	EzPro 610H	1		EV400 AF	yes	1	yes		
	C95	Micron PII 350		1	5' x 6' Dalite	EzPro 753	1		EV400 AF	Panasonic	1	Sony 27"	1	JVC 13"
	FND		1	1				yes	yes	yes	1	Zenith 64"	1	
	ISBDC/ Floater					Epson ELP 5550	1					Magnavox 27"	7	Panasonic
<b>Fine Arts</b>	119	(projector is a floater)			10' x 10' Dalite	EzPro 610H	1	yes	ProFect 4H	1	Magnavox 24"	1		
	121					EzPro 757	1	Peyvey System						

Building	Room	Computer	Laptop Access	Teaching Station	Screen	Projection System	Sound System	Elmo	VCR, Video	TV (size)	Monitor
	Floater										
<b>Gym</b>	104	Dell P4	1	1	8' x 8' Dalite	3M WP8030	SoundTech	EV400 AF	ProFect 4H	1	
<b>GRM</b>	101	Aurora Vision	3		10' x 10' Luma	EzPro 610H	Pyle Pro		Quasar	1	Quasar 24"
	114		1		white board	EzPro 615H	Koss		JVC 4H	3	Mitsubishi 24"
	Conf Rm			1	smart board	EzPro 757			dvd/vcr	1	
		Princeton Graphic System	2			EzPro 757					Zenith 60"
	201				yes	Infocus LP530	CV - Rex	EV4400 AF			
	210	yes	1	1					RCA	1	RCA 25"
	213	Dell P4	1	1					RCA	1	RCA 25"
	218	yes	1	1	10' x 10' Luma	EzPro 610H	no/ls wired		Quasar	1	
	231	yes	1	1	10' x 10' Luma	Infocus LP50			Emerson	2	Emerson 25"
	232	yes	1	1	10' x 10' Luma	Epson ELP 5550			RCA	1	RCA 25"
	233	yes	1	1	10' x 10' Luma	Epson ELP 5550	Pyle Pro	EV4400 AF	RCA	1	RCA 25"
	234	HP	1	1	yes	Infocus LP530	CV - Rex				RCA 48"
		Rick Allen Room	1		yes	Infocus LP820	?		yes	1	
		Library/ Conf Rm		1		EzPro 757					
			28	1	6' x 6'	EzPro 610H	no				
	102	Micron PIII 800MHz	1	1	8' x 8' Dalite	EzPro 757	SoundTech	EV400 AF	yes	1	
	103	DELL 9/04	1	1		EzPro 753	SoundTech		yes	1	
	108	DELL 8/02		1	yes	Polaroid PV235			Emerson	1	Emerson 25"
	109	Dell 01/03	1	1	8 x 8 Dalite	Polaroid PV235	no/ls wired		Quasar/on tv cart and one with projector unit	2	Mitsubishi 25"
		Kramer Switch									
	113	NO	1	1	yes	EzPro 750	no/ls wired				
	114	NO	1	1	yes	EzPro 750	no/ls wired				
	115	GreenerValley 1/0	1	1	10' x 10' Dalite	EzPro 610H	Bose	EV400 AF	?	1	Sony
	116	GreenerValley 1/0	1	1	10' x 10' Dalite	EzPro 610H	Bose	EV400 AF	Panasonic 4H	1	Sony
	117	Dell	1	1	yes	EzPro 750	Pyle Pro		Panasonic	1	
	118	Micron PIII 800MHz	1	1	yes	EzPro 610H	SoundTech	EV400 AF	Panasonic	1	

Building	Room	Computer	Laptop Access	Teaching Station	Screen	Projection System	Sound System	Elmo	VCR, Video	TV (size)	Monitor	
12/2003	201	Conner Creek	1	1	yes	EZPro 610H 1			RCA	1	Magnavox 25" 1	
	203	Dell	1	1	yes	EZPro 753 1	SoundTech		yes	1		
	204	Dell P4	1	1							Wacom	
	207	Dell P4	1		8' x 8' DalLite				Panasonic 4H	1	Mitsubishi 38" 1	
	209	Dell	1	1					JVC 4H	1	Zenith 60" 4	
	210	yes	1	1	yes	EZPro750 1	CV - Rex		yes			
	211	Conner Creek 550	24		wall paper	Polaroid 235 1						
	214			1	8' x 10'	EZPro 610H 1	Pyle Pro		yes		1	
	215	DELL P4		1	yes	Epson ELP 5550	SoundTech	wired	yes	1		
	216	Conner Creek	1	1	8' x 8' DalLite	EZPro753 1	Pyle Pro	wired	GE	1		
	223	Micron ClientPro CN-800		1	8 x 8 DalLite	EZPro 610H 1	SoundTech	wired	yes	1		
	224	Dell (8/2004)	1	1	yes	EZPro 757 1			yes	1		
Floater - B Eberlein												
Taylor												
	Admin					EZPro 610H 3						
	Shoppell					Infocus LP500 1		EV400 AF				
	247	Dell laptop	1		8 x 8 DalLite	EZPro 756 1		overhead		27" w/DVD	1	
	248				8 x 8 DalLite			overhead				
	277				12 x 12 manual							
	Student Services					Infocus LP530 1						
	"					EZPro 610H 1						
	"					EZPro 753 1						
	Teaching/Learning Center	Micron 866MHz	1	1	smart board	EZPro 615H 1	SoundTech		yes	1		
	Info Tech	spare				Infocus LP50 1						
	"					EZPro 615H 1						
	Instructional 10/02	spare (T3 purchase)				EZPro 750 1						
	"	spare (Taylor 12/03)				EZPro 750 1						
Burrey Center												
	floaters					Polaroid PV235 1						
	floaters					EZPro 753 1						
	Instructional 10/02					EZPro 750 1						
	A7	yes	1	1	yes	EZPro 610H 1	SoundTech	EV400 AF		Panasonic 1		
	10/2004 to be built					EZPro 757 1	Pyle Pro	EV400 AF		Panasonic VCR/DVD 1		
	Dell 9/04	1	1	1	8' x 8' DalLite	EZPro 757 1	SoundTech			JVC/stereo 1		
	B14	Conner Creek	1	1	yes	Polaroid PV211E 1		EV400 AF		yes	1	
GND												





Building	Room	Computer	Laptop Access Station	Teaching Station	Screen	Projection System	Sound System	Elmo	VCR, Video	TV (size)	Monitor
Dorm		equipment installed in RA Office			10' x 10' Dalite	EzPro 753	SoundTech		dvd and vcr		
Hailey Center	floatier					EzPro 753					
	computer lab			1		EzPro 753					
	Telecom Rm			1		EzPro 753	SoundTech	EV400AF	yes	27" Thomson - Wilson Bates	2
Gooding Center	Telecom Rm							EV400AF			
Micron - Boise						EzPro 753				52" - Costco	2
Ron Shopbell - floaters - apprentice program											
						EzPro 610H				5	
<b>TOTAL</b>		<b>233</b>	<b>47</b>	<b>64</b>					<b>69</b>	<b>111</b>	<b>53</b>



Appendix 8.7
Example of Work Order

WORK ORDER

3642

DATE \_\_\_\_\_ JOB RESPONSE \_\_\_\_\_ REQUEST \_\_\_\_\_
TIME \_\_\_\_\_ EMERGENCY \_\_\_\_\_ 1ST \_\_\_\_\_
NAME \_\_\_\_\_ ASAP \_\_\_\_\_ 2ND \_\_\_\_\_
LOCATION \_\_\_\_\_ EXT. \_\_\_\_\_ 3RD \_\_\_\_\_
COMMENTS \_\_\_\_\_

MESSAGE TAKEN BY \_\_\_\_\_ PAGED TO \_\_\_\_\_
JOB COMPLETED \_\_\_\_\_
COMMENTS \_\_\_\_\_

## Appendix 8.8 Fall 2003 Accreditation Survey Questions #61, #62, #63, and #64

### Question #61

Would you agree that:	Total					Total Percent in Agreement	Total Percent in Disagreement
	SD	D	A	SA	DK/NA		
Classrooms and work areas are kept in good condition (clean, well lit, paint, ceiling and floor coverings)?	0.7%	1.8%	53.0%	41.5%	3.0%	94.5%	2.5%

KEY: SD=Strongly Disagree D=Disagree A=Agree SA=Strongly Agree DK/NA=No Opinion/Does Not Apply.  
Includes responses from fall 2003 survey of students, faculty, staff and administration.

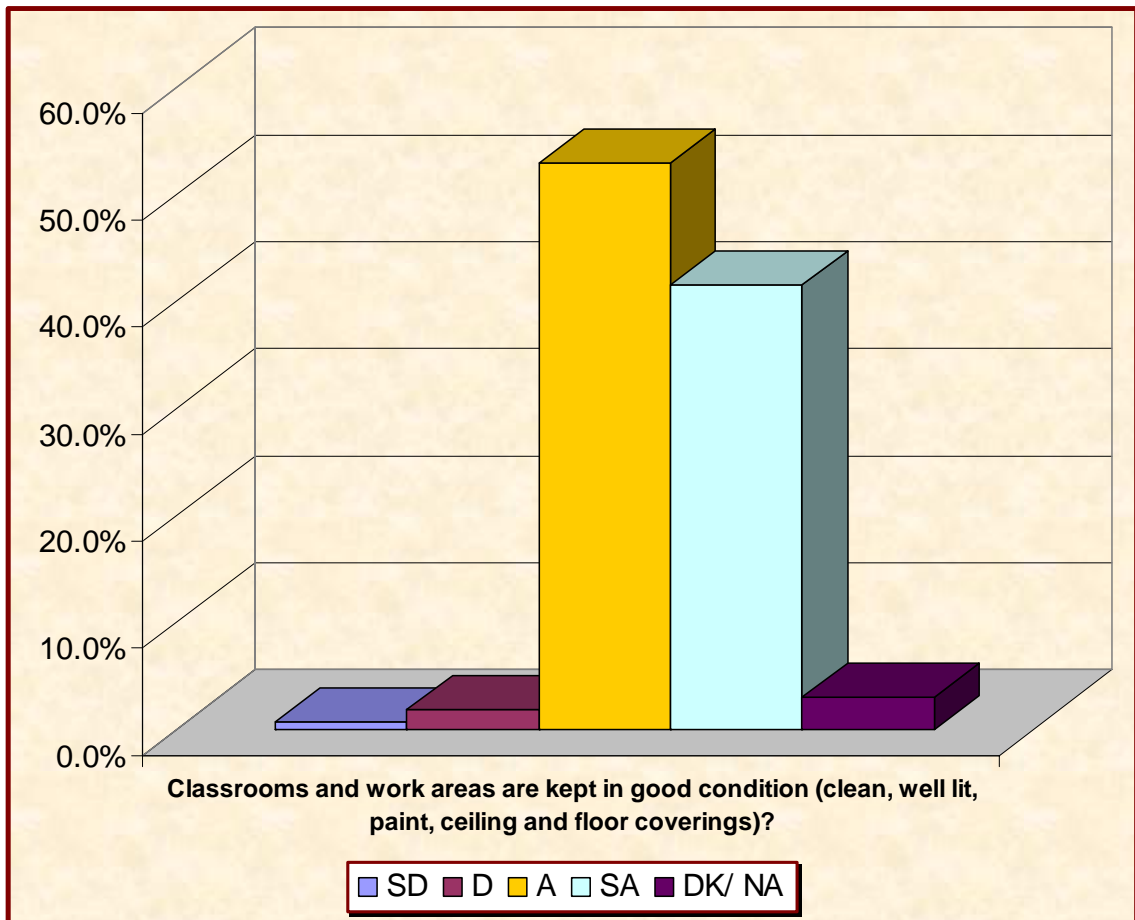

Question #62

Would you agree that:	Total					Total Percent in Agreement	Total Percent in Disagreement
	SD	D	A	SA	DK/NA		
Campus buildings are generally kept clean?	0.8%	0.7%	50.2%	45.3%	3.0%	95.5%	1.5%

KEY: SD=Strongly Disagree D=Disagree A=Agree SA=Strongly Agree DK/NA=No Opinion/Does Not Apply.

Includes responses from fall 2003 survey of students, faculty, staff and administration.

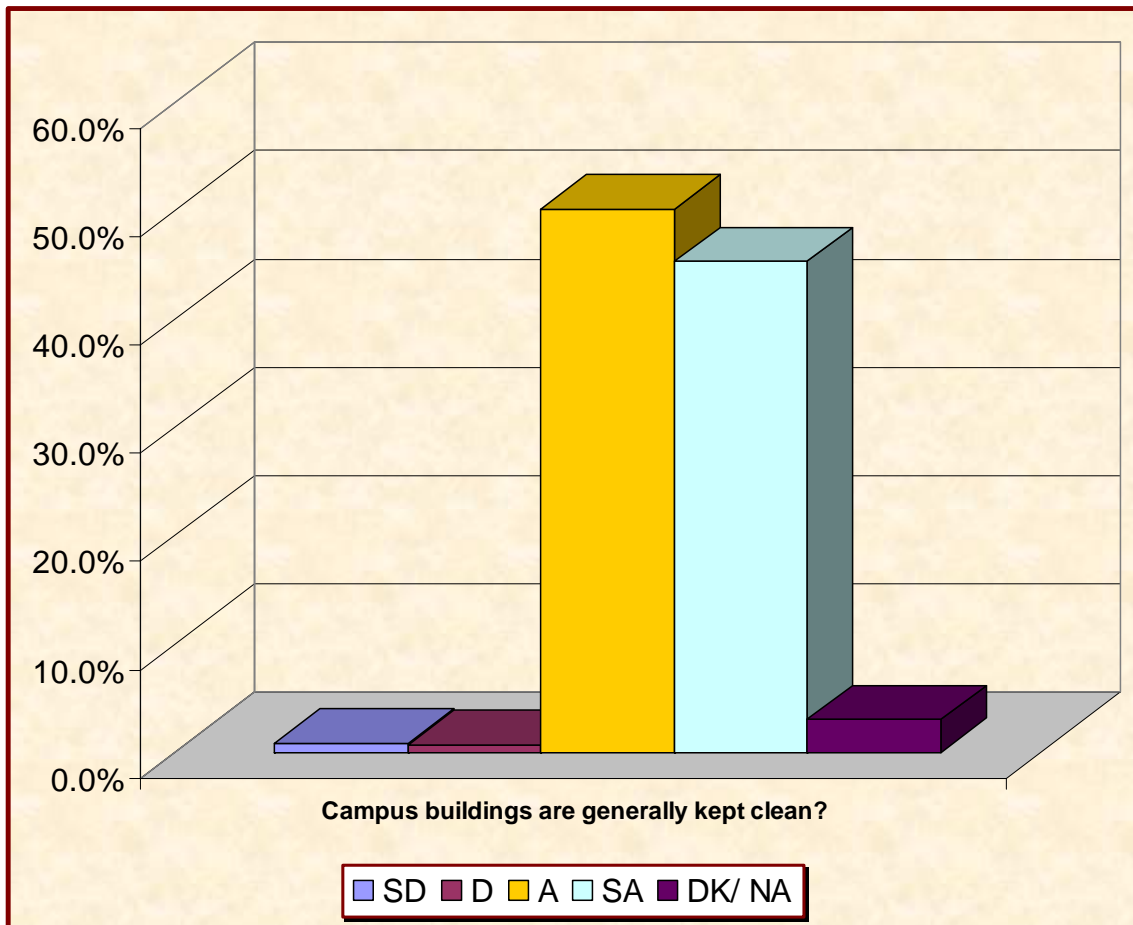

Question #63

Would you agree that:	Total					Total Percent in Agreement	Total Percent in Disagreement
	SD	D	A	SA	DK/NA		
Campus snow and ice removal are adequate?	0.7%	3.3%	53.1%	31.3%	11.6%	84.4%	4.0%

KEY: SD=Strongly Disagree D=Disagree A=Agree SA=Strongly Agree DK/NA=No Opinion/Does Not Apply.

Includes responses from fall 2003 survey of students, faculty, staff and administration.

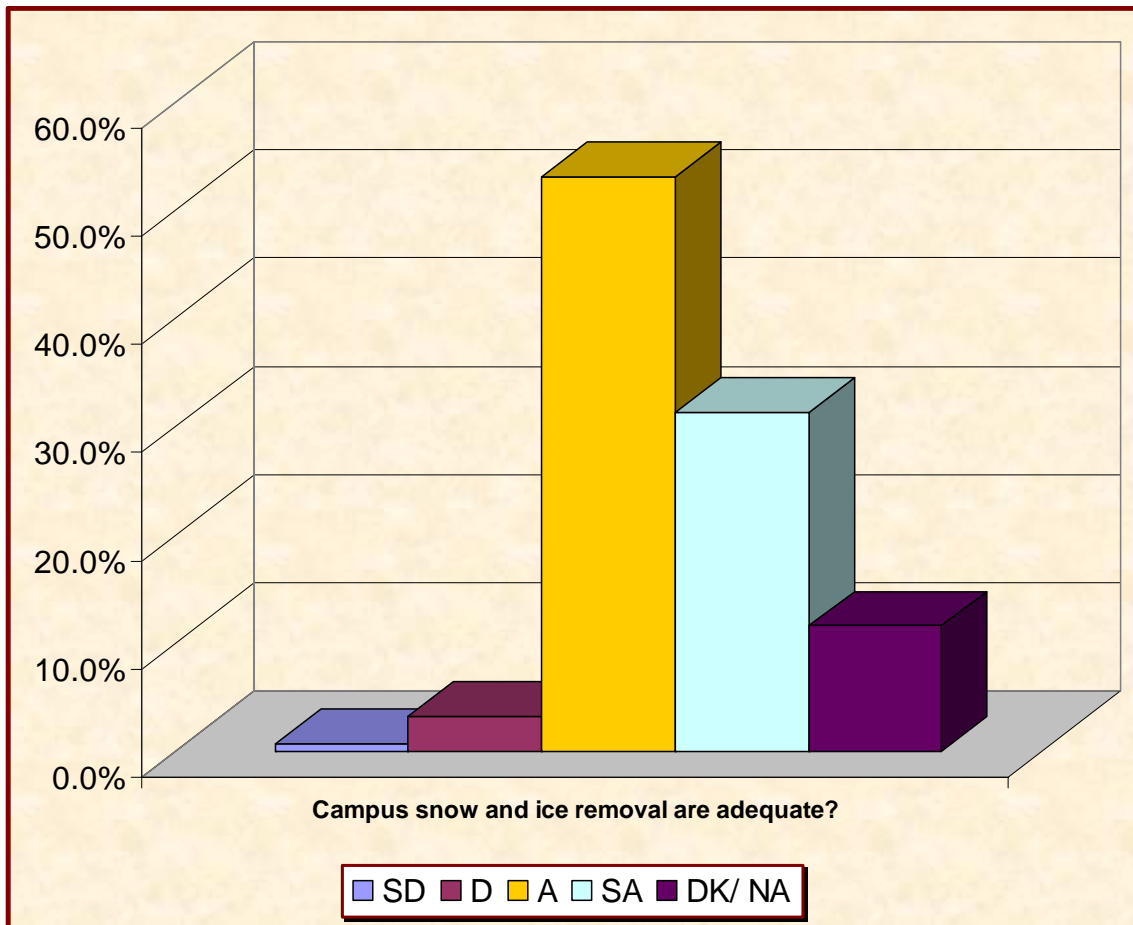

Question #64

Would you agree that:	Total					Total Percent in Agreement	Total Percent in Disagreement
	SD	D	A	SA	DK/ NA		
Campus landscaping is adequately maintained?	1.3%	3.1%	40.9%	50.9%	3.8%	91.8%	4.4%

KEY: SD=Strongly Disagree D=Disagree A=Agree SA=Strongly Agree DK/NA=No Opinion/Does Not Apply.  
Includes responses from fall 2003 survey of students, faculty, staff and administration.

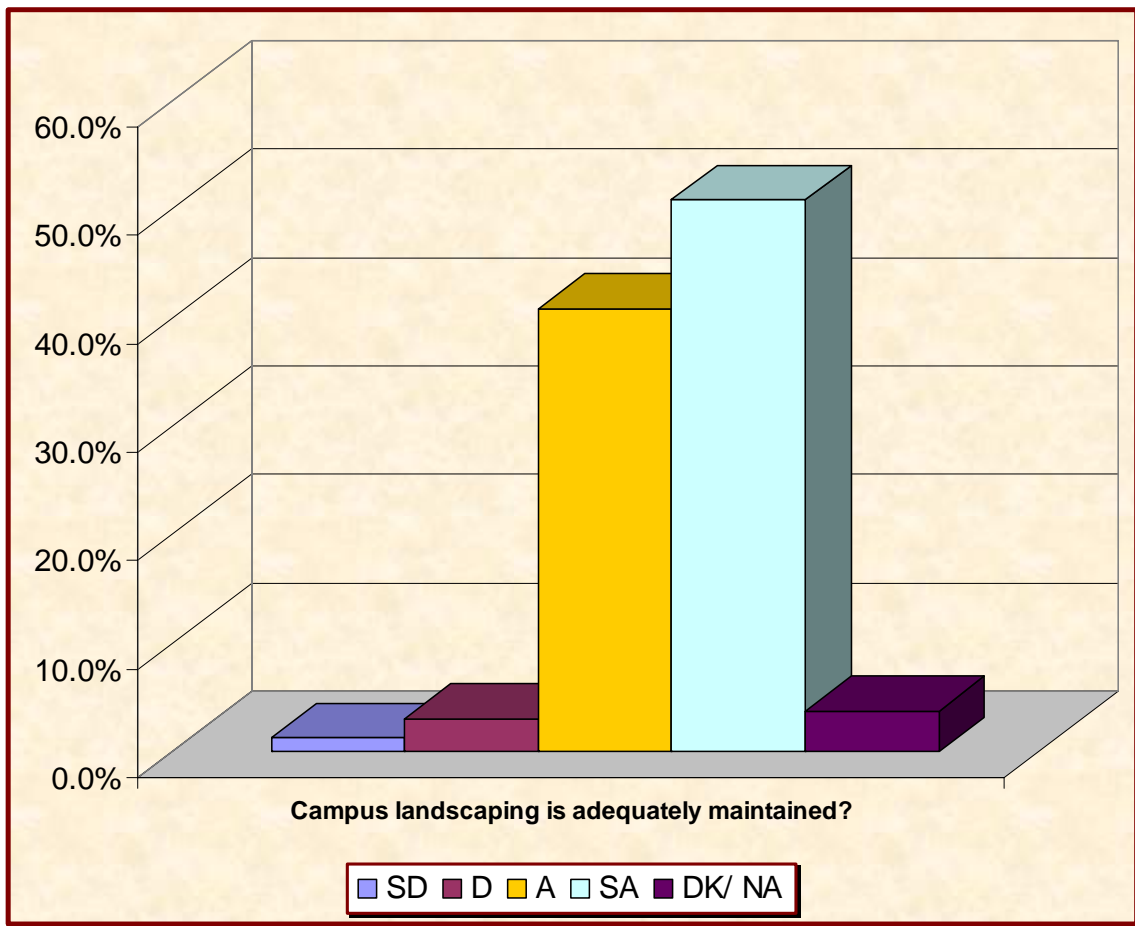

# Appendix 8.9 Emergency Phone Runner Tree

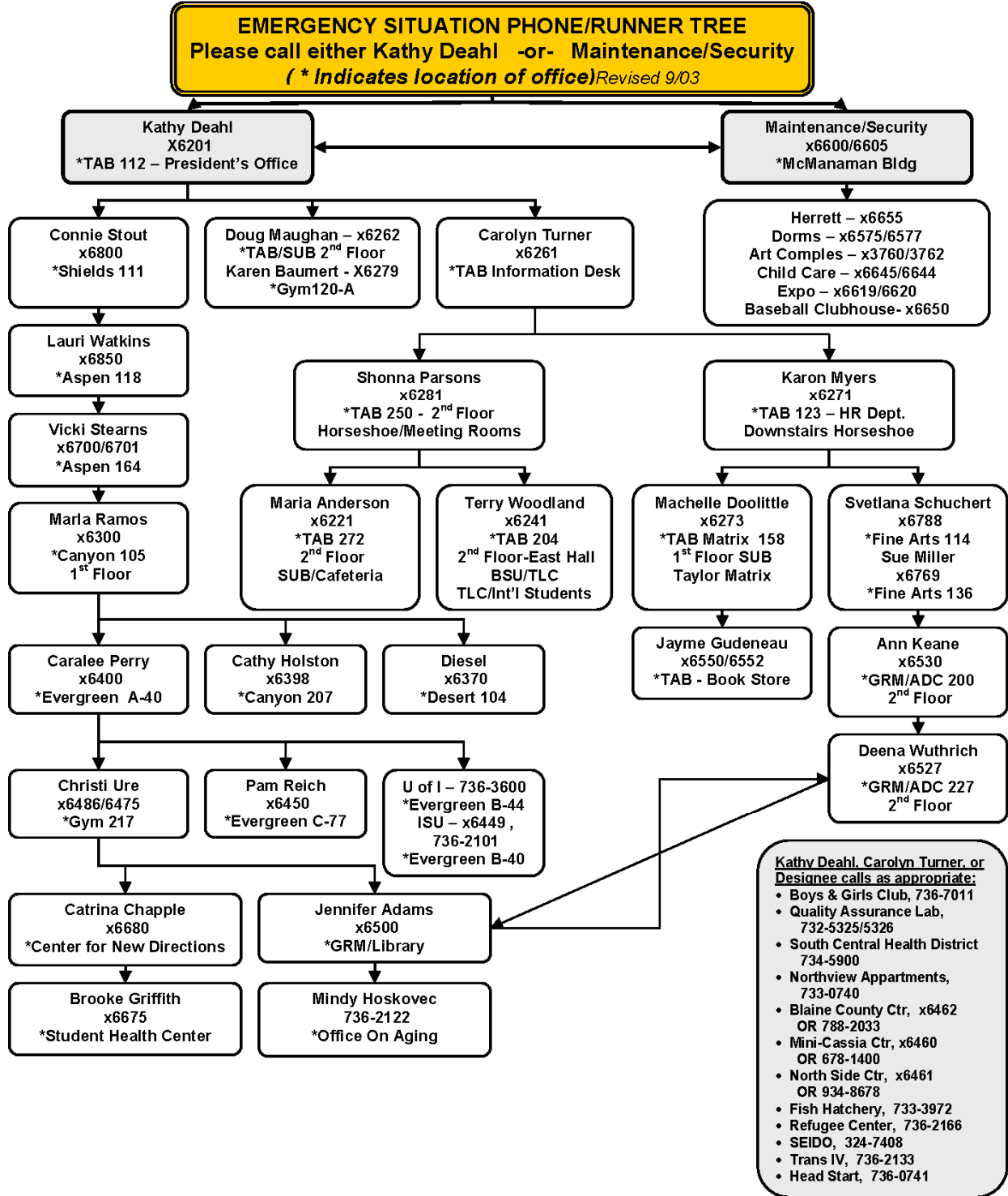

**Appendix 8.10  
Graph Depicting Decrease in Professional-Technical  
Capital Outlay**

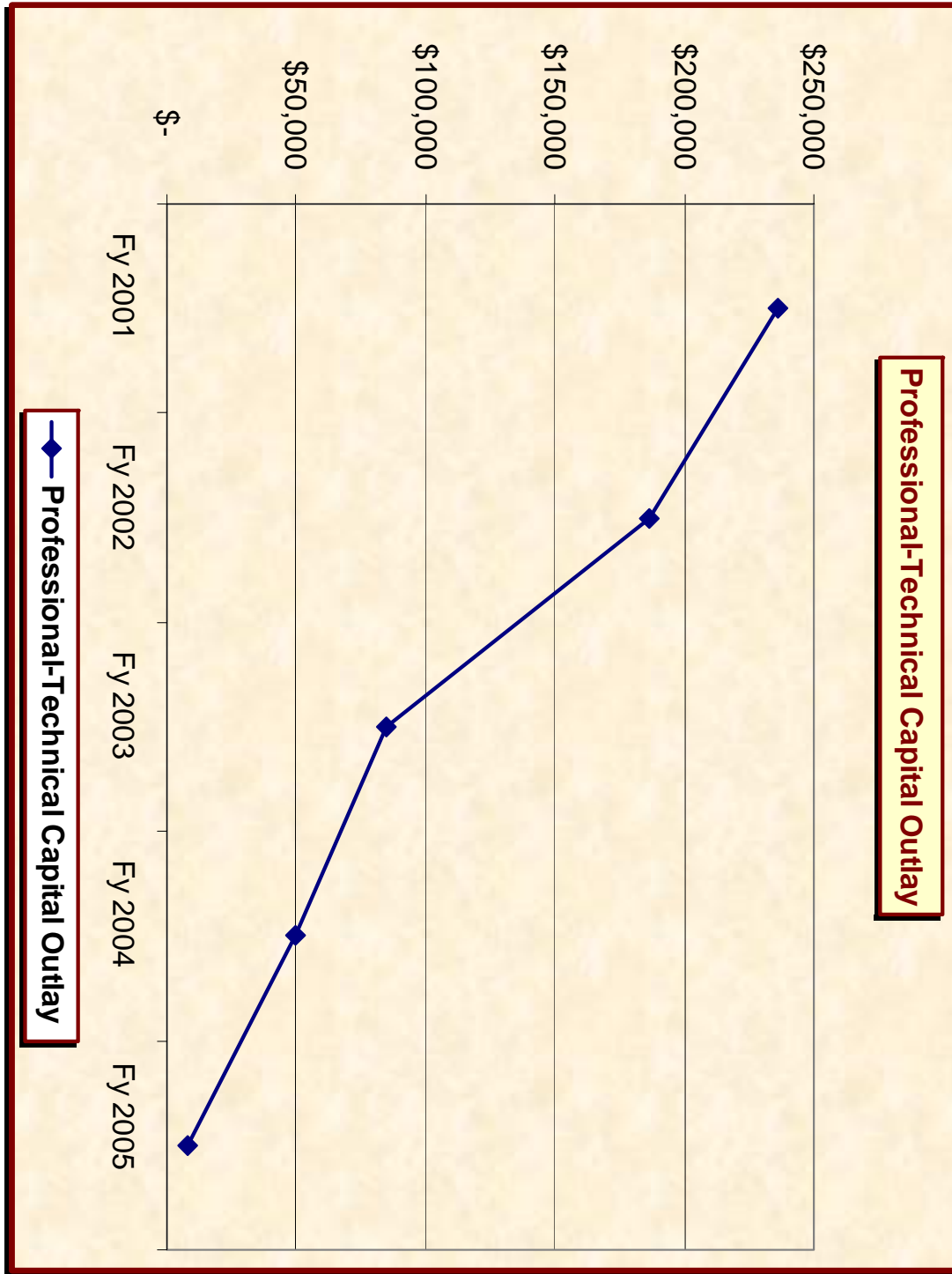



## Appendix 8.11 Historical Plant Facility Fund Balance





# Appendix 8.12 Plant Facility Fund Projections

<b>COLLEGE OF SOUTHERN IDAHO</b>			
<b>PLANT FACILITY FUND PROJECTIONS - FY 04</b>			
December 9, 2003			
<b>FY 2004 BEGINNING FUND BALANCE</b>			<b>\$ 1,212,800</b>
<b>REVENUES</b>			
4410	INTEREST ON INVESTMENTS	\$ 4,600	
4411	WATER LEASE/MISC	\$ 4,200	
4412	RECYCLING INCOME	\$ 200	
4460	RENTAL INCOME	\$ 92,400	
4998	TRANSFERS - GENERAL FUND	\$ 623,400	
4998	TRANSFERS - BOOKSTORE	\$ 100,000	
	FY 2004 INCOME		\$ 824,800
	<b>FY 2004 - TOTAL FUNDS</b>		<b>\$ 2,037,600.00</b>
<b>APPROVED PROJECT EXPENDITURES</b>			
		<b>ACTUAL FY 04</b>	<b>ESTIMATED</b>
		<b>EXPEND TO DATE</b>	<b>COST</b>
5230	MISC SERVICES		\$ 300
5510	TAYLOR REMODEL		\$ 20,000
5550	INSURANCE EXP/REIMBURSE		
5559	GRAVEL PARKING LOT-FY 03		\$ 39,700
5564	MAINT PAINT BOOTH		\$ 30,000
5565	HAILEY S.D. REMODEL		\$ 20,000
5574	CANYON AHUJ1 REPLACEMENT	\$ 3,200	\$ 35,000
5576	BURLEY TESTING CENTER		\$ 50,000
5586	ATHLETICS-MIS	\$ 3,000	\$ 3,000
5593	DPW CHILLER PROJECT-FY 03	\$ 45,600	\$ 75,000
	ELECT PANEL UNDER TOWER		\$ 30,000
	ASPEN AH AND RETURN FAN		\$ 35,000
	BURLEY DOOR REPLACEMENT		\$ 35,000
	ACID WASH BLDG- ANNUAL		\$ 30,000
	SHIELDS/ASPEN N. FIRELANE		\$ 5,000
	CHILLER ELCT PANEL REPLACEMENT		\$ 16,000



**COLLEGE OF SOUTHERN IDAHO  
PLANT FACILITY FUND PROJECTIONS - FY 04**

December 9, 2003

	EVERGREEN C WING DUCTING	\$	40,000	
	ART ANNEX HVAC ISSUES	\$	7,000	
	SHIELDS LIGHTING RETROFIT	\$	35,000	
	SHIELDS GEO HEAT PUMP SYS	\$	45,000	
	DEMOLISH SCOTTS BLDGS	\$	15,000	
	MEYER BLDG GEO UPGRADE	\$	5,000	
5997	TRANSFER TO FA ADDITION	\$	540,000	
	<b>TOTAL EST APPROVED EXPEND.</b>	<b>\$</b>	<b>51,800</b>	<b>\$ 1,111,000</b>
	<b>OTHER POSSIBLE PROJECTS</b>			
5579	PURCHASE OF MADRONA PROP.	\$	96,000	
	REMODEL MADRONA PROP.	\$	10,000	
	MCI BUS PURCHASE	\$	125,000	
5997	TRANSFER TO HERRETT ADDITION	\$	300,000	
5997	TRANSFER TO STUDENT UNION	\$	390,000	
	<b>TOTAL POSSIBLE PROJECTS</b>	<b>\$</b>	<b>921,000</b>	
	<b>ESTIMATED FY 05 BEGINNING</b>			
	<b>FUND BALANCE IF ALL OF THE ABOVE PROJECTS</b>			
	<b>ARE COMPLETED</b>	\$	5,600	
	TRANSFER FROM GENERAL FUND IN FY 04	\$	2,136,600	
	<b>ESTIMATED FY 05 BEGINNING FUND BALANCE</b>	<b>\$</b>	<b>2,142,200</b>	
	<b>POSSIBLE PROJECTS FOR FY 05</b>			
	FA ADDITION FURNITURE	\$	150,000	
	BURLEY H.S. PARKING LOT	\$	55,000	NOT ELIGB FOR DPW
	CHILD CARE HVAC	\$	4,500	
	REPLACE EXPO ELEC PANELS	\$	5,000	
	TENNIS COURT SHELTER	\$	25,000	



**COLLEGE OF SOUTHERN IDAHO  
PLANT FACILITY FUND PROJECTIONS - FY 04**

December 9, 2003

EXPO CEILING INSULATION	\$	15,000	
INFO OFFICE & TAYLOR REMODEL	\$	25,000	
SIDEWALK REPLACEMENT	\$	10,000	
SWI-CITY PROJECT- PUMP	\$	45,000	
SIDC CHILLER REPLACEMENT	\$	20,000	LOW PRIORITY
OFFICE ON AGING NEW BLDG	\$	300,000	
DORM A/C-BOYS-74 ROOM@ \$3,500	\$	262,500	NOT ELIGB FOR DPW
BOYS ROOM RETROFIT @ \$4,000	\$	300,000	NOT ELIGB FOR DPW
NORTHVIEW SIDING	\$	65,000	NOT ELIGB FOR DPW
NORTHVIEW FIRE ALARM SYSTEM	\$	55,000	NOT ELIGB FOR DPW
<b>TOTAL PROJECT COST</b>	<b>\$</b>	<b>1,337,000</b>	
<b>APPROVE DPW PROJECTS FOR FY 04</b>			
SCOTTS BULDING ROOF	\$	68,100	
CANYON FIRE ALARM SYSTEM	\$	43,700	IN PROGRESS
MAINT PAINT BOOTH	\$	115,000	IN PROGRESS
SWI EXPANSION	\$	80,000	IN PROGRESS
CHIPSEAL CAMPUS CIRCLE ROAD	\$	105,300	IN PROGRESS
<b>TOTAL</b>	<b>\$</b>	<b>412,100</b>	
<b>DPW FY 05 REQUEST-FUNDING RECOMMENDED BY DPW</b>			
CAMPUS FIRE LANE	\$	100,000	
ASPEN AIR HANDLER	\$	60,000	
FINE ARTS HVAC RETRO FIT	\$	65,000	
CANYON BUILDING AIR HANDLERS	\$	109,000	
NEW PARKING LOT SEAL COATING	\$	78,000	
<b>TOTAL</b>	<b>\$</b>	<b>412,000</b>	
<b>DPW FY 05 REQUESTS NOT RECOMMENDED BY DPW</b>			



<b>COLLEGE OF SOUTHERN IDAHO</b>			
<b>PLANT FACILITY FUND PROJECTIONS - FY 04</b>			
December 9, 2003			
EXPO GAS RETROFIT	\$	144,600	
RESURFACE BAYS 9-16	\$	300,000	
RESURFACE BAYS 1-16	\$	188,000	
EXPO PARKING LOT RESURFACE	\$	293,600	
PAVE GRAVEL PARKING LOT	\$	157,600	
SEAL COAT EAST PARKING LOT	\$	72,600	
<b>TOTAL</b>	<b>\$</b>	<b>1,156,400</b>	
<b>FUTURE PROJECTS</b>			
CARD KEYLOCK SYSTEM-CAMPUS	\$	250,000	ROUGH EST
GYM LIGHT RETROFIT	\$	50,000	
CAMPUS LIGHT POLE REPLACEMENT	\$	270,000	ROUGH EST
SIDEWALK REPLACEMENT	\$	200,000	ROUGH EST
NORTH CAMPUS INFRASTRUCTURE	\$	1,000,000	ROUGH EST
CAMPUS INGRESS/EGRESS	\$	300,000	ROUGH EST
<b>TOTAL</b>	<b>\$</b>	<b>2,070,000</b>	

# Appendix 8.13 Herrett Center Map and Information

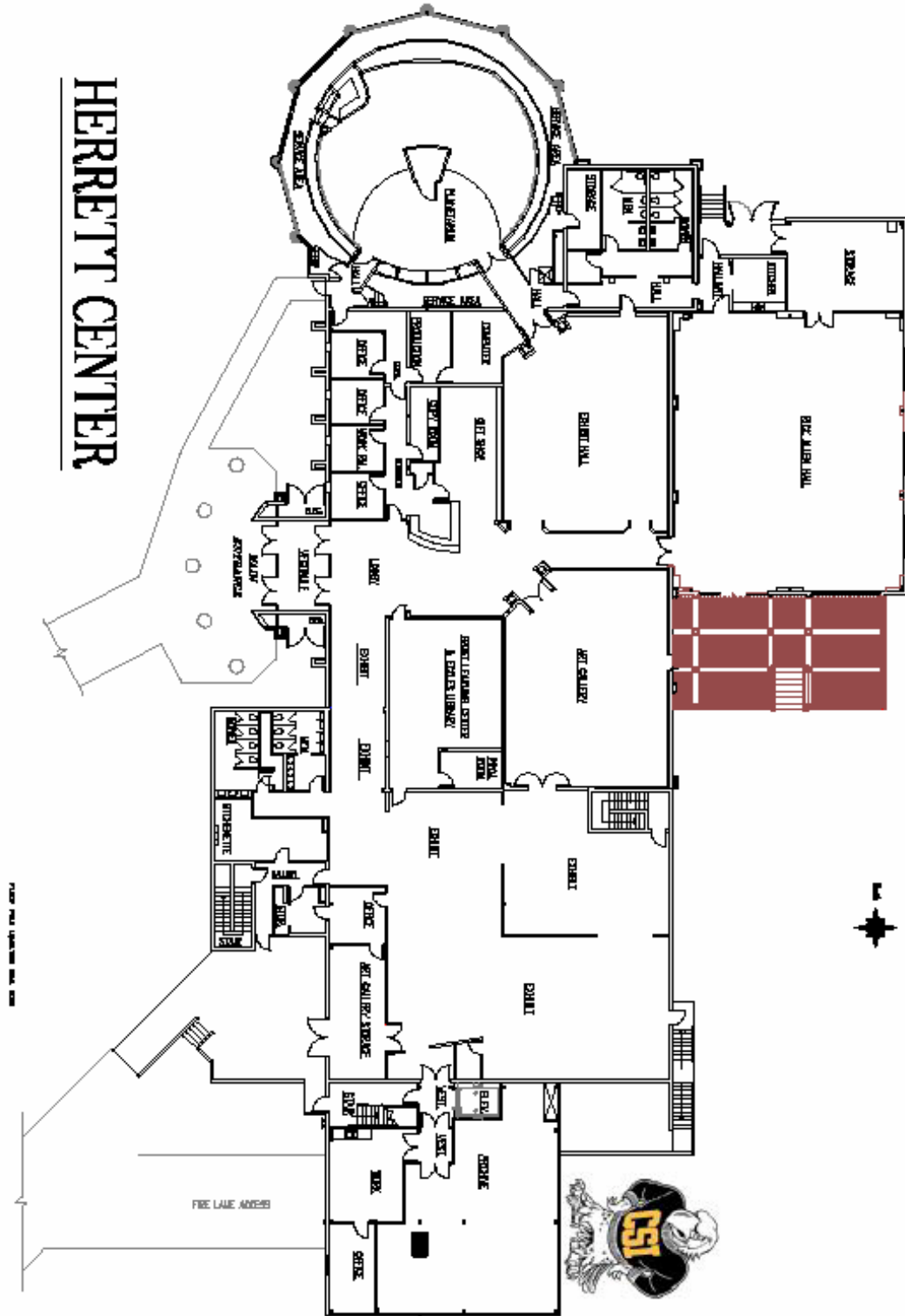

# Appendix 8.14 Blaine County Outreach Center Map

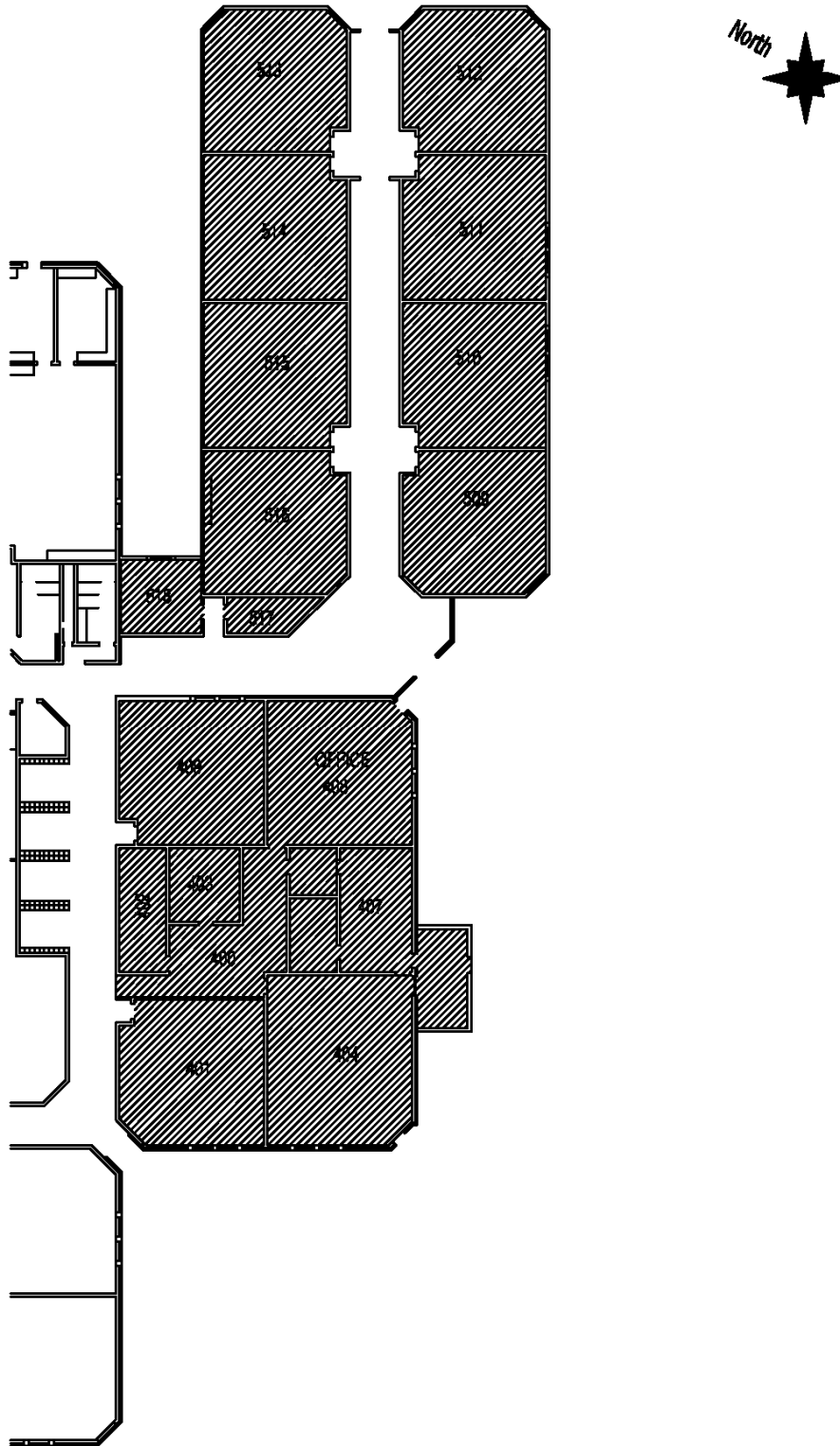

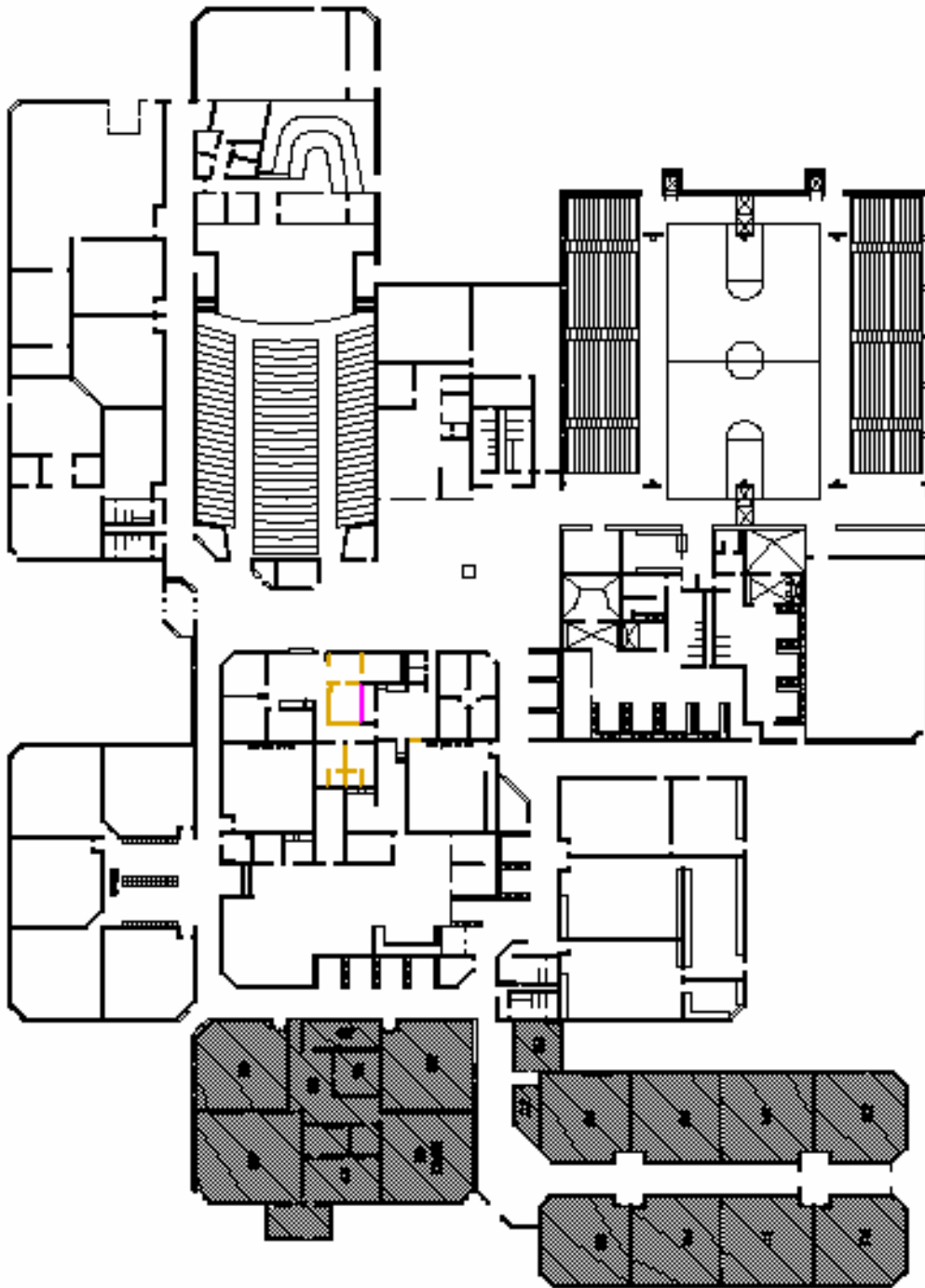



# Appendix 8.15 Mini-Cassia Outreach Center Map

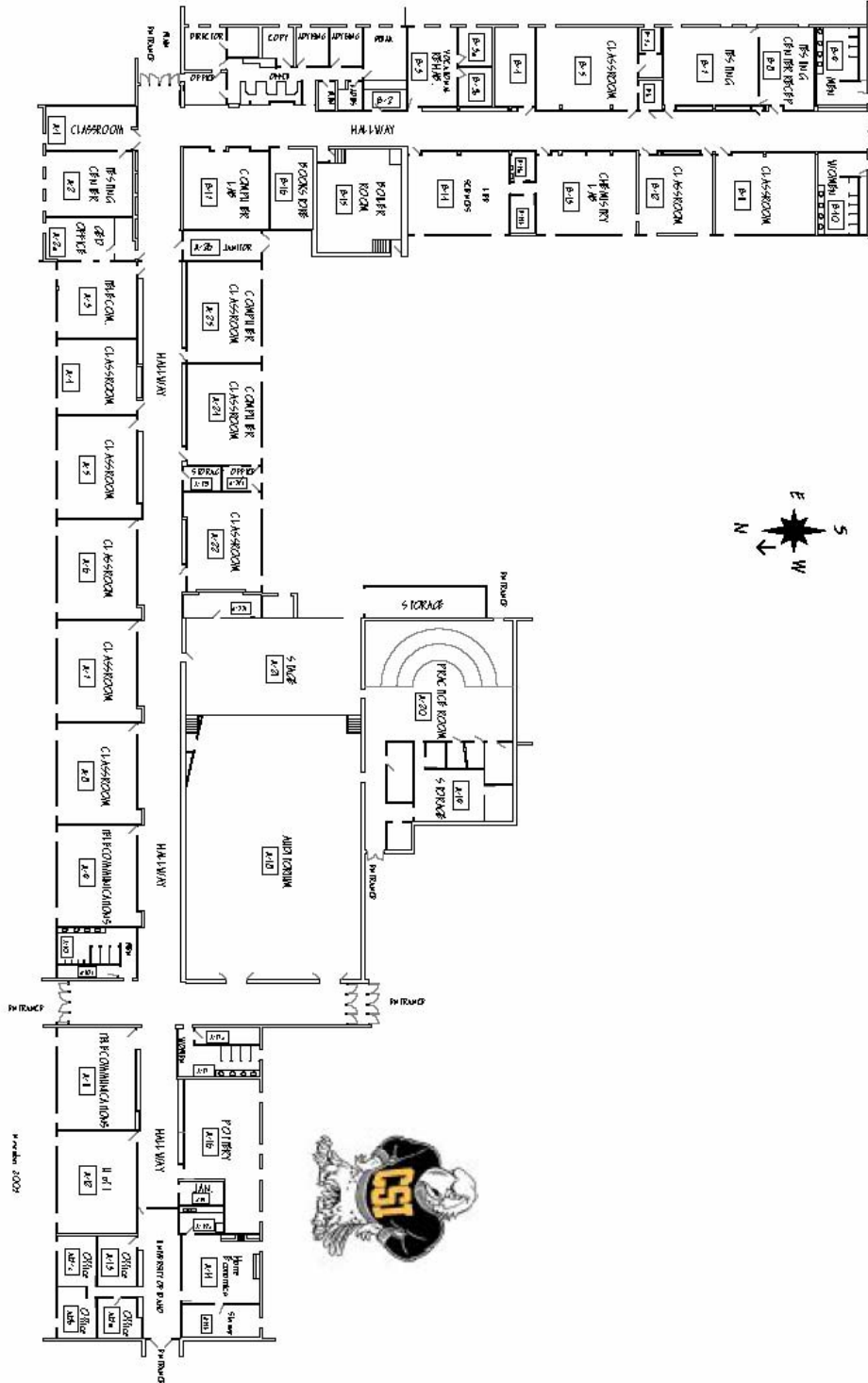

# Appendix 8.16 North Side Outreach Center Map

